

Replacement parts:

# SATA Charcoal Filter and Industrial Belt Units

NIOSH Approval TC-19C-210 and TC-19C-211

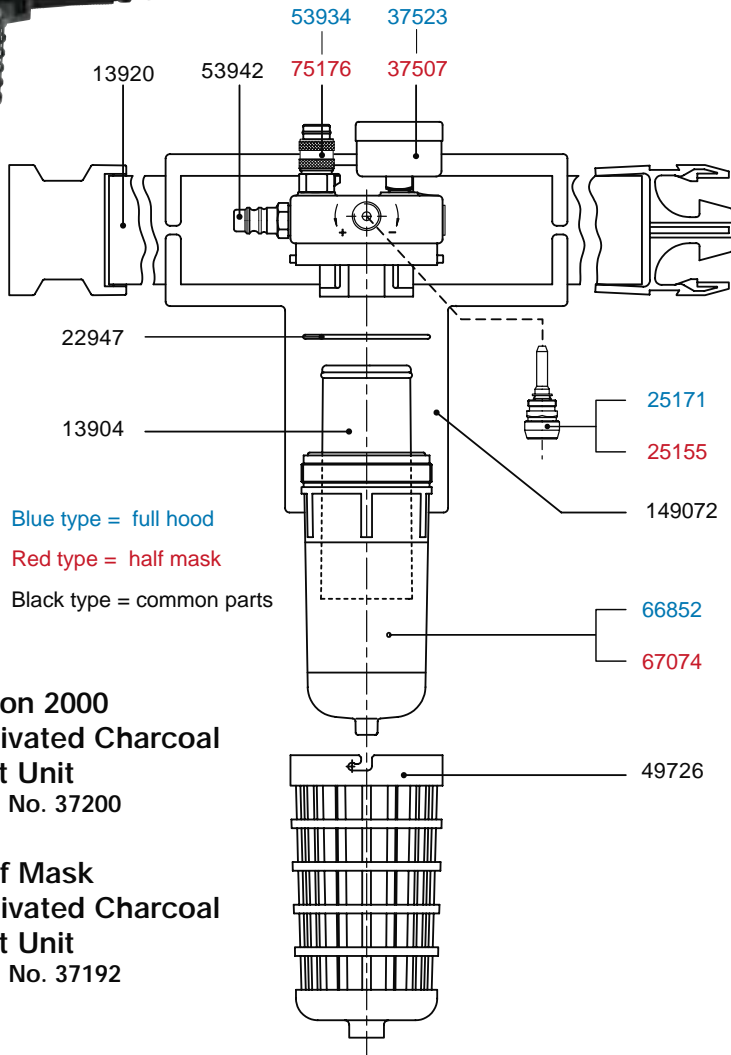

Blue type = full hood

Red type = half mask

Black type = common parts

**vision 2000  
Activated Charcoal  
Belt Unit**  
Part No. 37200

**Half Mask  
Activated Charcoal  
Belt Unit**  
Part No. 37192

**Part # Description**

109	Air inlet fitting, 1/4" BSP
1503	Air control screw
13656	Female threaded nipple
13904	Charcoal filter cartridge
13920	Waist belt
15412	Belt unit support straps
22947	"O" ring, housing
25155	Regulating valve, half mask
25171	Regulating valve, vision 2000
37192	Belt unit, complete half mask
37200	Belt unit, complete vision 2000
37507	Gauge, half mask
37523	Gauge, vision 2000
48934	Air micrometer w/o gauge
49726	Protective filter cover
51656	T fitting, (supplied separately)
53934	Full hood QC
53942	Nipple, T fitting
54221	Control valve
61002	Belt valve complete, vision 2000
61457	Belt valve, complete half mask
65557	Knob, control valve
66852	Filter cover
75176	Half mask QC
55640	52" Paint whip hose
149872	Belt cushion

**Replacement parts for discontinued belt units #66829 and #66894**

783	Male nipple, Milton
784	Female nipple, Milton
53959	Detent, regulator valve



**vision 2000  
Industrial Belt Valve**  
Part No. 61002

**Half Mask  
Industrial Belt Valve**  
Part No. 61457

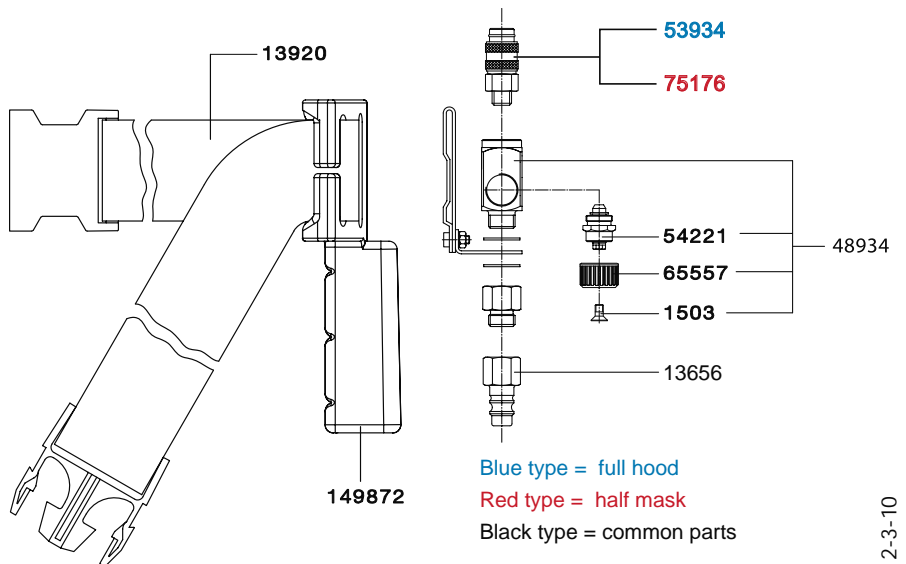

Blue type = full hood

Red type = half mask

Black type = common parts